

**CITY OF CLAWSON
OAKLAND COUNTY, MICHIGAN
STREET MAP**

- Key:**
- Municipal
 - ▲ Post Office
 - ⚓ Schools
 - ⚓ Churches
 - Bike Racks
 - * Proposed Crossing Island
 - Proposed Bike Path
 - Downtown Route
 - use of Sidewalk
 - Feeder Lines to Bike Park Station
 - Proposed Link to Surrounding Communities

A	Allen	N-14	K	Kenilworth	C-3
	Alyssa Lane	P-1		Key West	F-20
	Anderson	B-1		Kinross	I-5
				Knollwood	E-10
B	Badder	F-18	L	Langley	E-3, F-3
	E. Baker	H-12		Lerner	I-15
	W. Baker	G-5, G-9		Leroy	C-10
	N. Batchewana	I-2		Lincoln	J-11
	S. Batchewana	N-2		Lapla	I-11
	Bauman	O-11			
	Bellevue	L-14	M		
	Boschma	I-14		Madison	L-9
	Bowers	I-11, J-16		N. Main	B-11
	Broadacre	J-10		S. Main	O-11
	N. Bywood	J-6, C-7		N. Mainitou	J-4
	S. Bywood	N-6		S. Mainitou	N-4
				W. Maple	A-9
C	Charlevoix	M-8		Marc	C-5
	Chippewa	O-8		N. Marias	J-5
	N. Chocolate	J-3		S. Marias	N-5
	S. Chocolate	N-3		Massoit	O-8, O-3
	Church	L-12		Michael Court	P-1
	Coolidge	J-17			
	Council	A-9	N		
	N. Crooks	E-1		Nahma	M-3, N-7
	S. Crooks	N-1		Nakota	M-8
	Curtis	F-1		Normandy	P-1
	N. Custer	H-7, B-8	O		
	S. Custer	K-8		Oakley	B-8
D	Darbee	H-4	P		
	Donald	N-14		Pare	K-13
	Dreon	A-4		Park	D-10
				Parkland	M-14
E	Elmsford	D-4, E-9	R	Patterson	G-7
	E. Elmwood	F-14		Phillips	G-4, H-9
	W. Elmwood	F-7			
	Essex	K-21			
F	Fisher	I-11	S		
	Florence	I-12		Samoset	L-3
	E. 14 Mile	K-14		School	B-4, B-9
	W. 14 Mile	K-6		N. Selfridge	E-5
G	Gardner	K-14, L-11		W. Selfridge	H-1
	Gargantua	N-4		Shenandoah	C-4, E-4, G-1
	Gerald	L-8		Stephen	D-6
	Gladwin	N-11		Straub	H-10, I-10
	Goodale	H-17			
	Goodale Ct.	I-16	T		
	Gordon	G-21		E. Tacoma	L-11
	Grant	I-17		W. Tacoma	L-8
	Grove	L-14		Tecumseh	N-8
H	Hendrickson	G-16	W		
	High	F-14, I-14, K-13		Walper	M-11
	Highland	F-5, G-9		N. Washington	J-9
	Hudson	G-19		S. Washington	N-9
	Huntley	K-20		N. Webik	I-2
				S. Webik	N-2
				Wilson	G-20, K-20
J	Jefferson	K-10		Wright	C-4
	John M.	I-6			

SCHOOLS		CHURCHES	
Board of Education	H-6	Crossroads Church	I-11
Clawson High	I-9	Bethany Baptist	K-8
Clawson Middle	I-9	Church of Christ	K-14
Guardian Angel	K-15	Clawson Methodist	J-11
Kenwood	L-7	Grace Apostolic Church	F-15
Schalm	F-5	Guardian Angel	K-15
		Intercessions Word Ministry	P-3
		Trinity Lutheran	K-5

MUNICIPAL BUILDINGS		
Blair Memorial Library	H-11	586-5500
City Hall	I-11	435-4500
City Park	F-9	589-0334
City Sporting Facilities	F-7	589-0334
Department of Public Works Compound	F-6	286-3222
Fire Department	L-12	435-5000
Historical Museum	I-12	588-9169
Hunter Community Center	I-14	589-0334
Police Department	I-11	435-5000
Post Office	I-11	435-0555

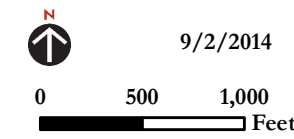

Data Source: Oakland County GIS, 3rd Quarter Update, 2006.

